

Our all-in-all handheld smart terminal device with scanner

SurfTouch

Card payments	Contact chip and contactless with PIN. Contactless reader on the screen
CPU	Quad Core ARM Cortex-A53 - 1.8 GHz, Secure ARM Cortex M4
Memory	1 GB RAM, 8 GB Flash (optional), 2 GB RAM, 16 GB Flash (optional)
Operating System	Android 10
Main camera	5 megapixels, fixed focus, 70 lm flash light
Buttons	On/Off button, 2 scan buttons
Display	5-inch mutual capacitance touch 720 x 1280 px
Sensors	Accelerometer Proximity sensor, Light sensor
Smart card reader	Friction type
Contactless reader	NFC-A, ISO 14443 Type A, NFC-B, ISO 14443 Type B, NFC-F, Felica NFC-V, ISO 15693
Contactless payments	VISA payWave, MasterCard PayPass, American Express, DPAS (Discover)
Barcode reader	2D Zebra SE4710 - 1280 x 800 CMOS
Connectors	2 x nano SIM card slots, SAM card slot, Micro SD card slot (max 32 GB), RS-232 contact pins, USB Type-C port 3.5 mm, TRRS port
Wireless	IEEE 802.11 a/b/g/n/ac, 2.4 GHz and 5 GHz
Cellular	2G/3G/4G
Battery	Rechargeable Li-Ion Battery, 4.35 V, 2500 mAh, Coin Cell, 3 V, 120 mAh
Reliability	500,000 chip card cycles
Certificates	CE, FCC, ROHS, CB, BIS, UN38.3, PCI PTS 5.x SRED, EMV Level 1, EMV Level 2, EMV Level 1 Contactless
Dimensions W x D x H	144 x 77 x 16 mm
Weight	208 g
Drop tested	1.2 m, faces and edges
Operational	-10 °C to 50 °C

Accessories



Charger stand with printer

Including printer and cable



Charger stand

Including cable



Rugged case

For tough environments

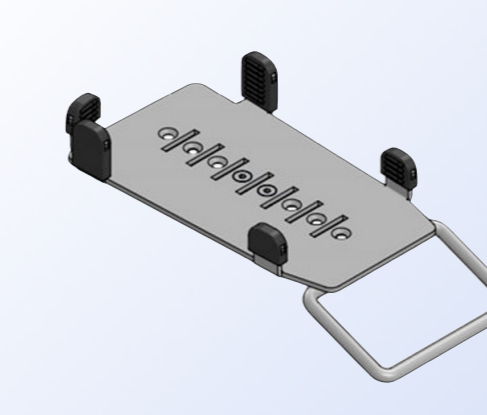

Multigrip Handle

Holder for the terminal



DuraTilt Counter

Metallic stand for handle



Mounting Pole

Plastic stand for handle